

# The Museum House

Residence No.

# 5B

805 Washington Avenue  
Prospect Park, Brooklyn, New York, 11238

info@themuseumhouse.com  
themuseumhouse.com

+1 718 650 5805

---

One Bedroom

One Bath

803 sf interior

93 sf exterior

---

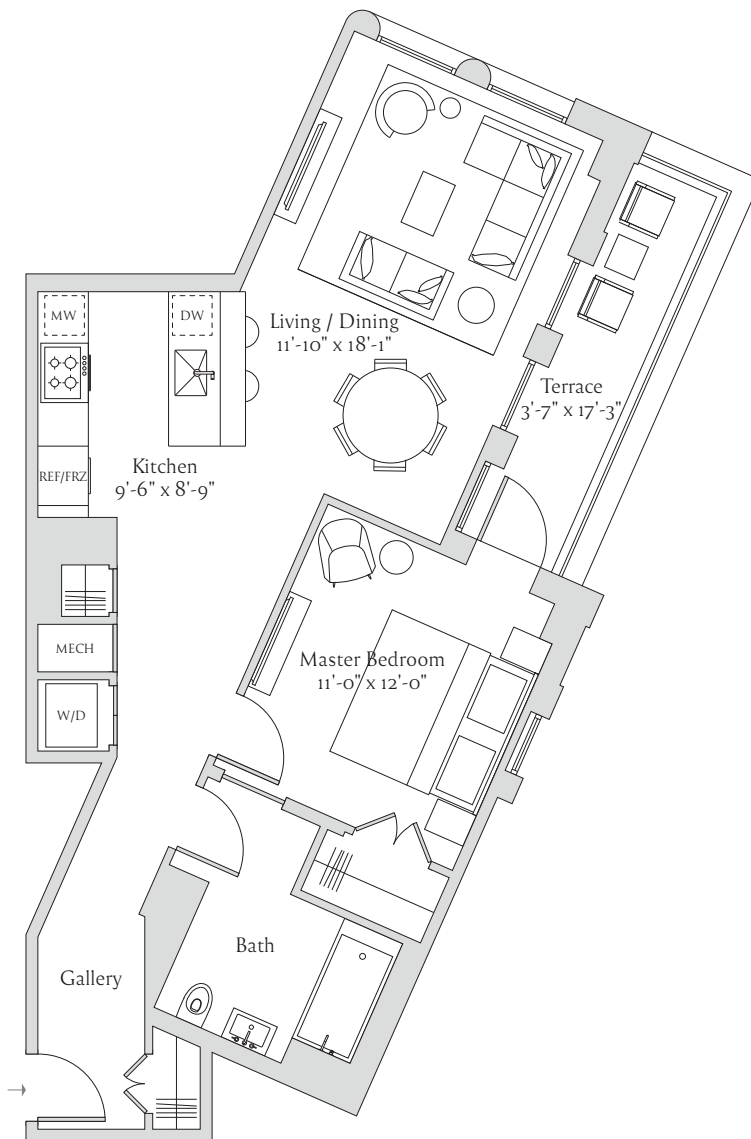

- Gracious layouts boast Natural White Oak flooring crafted in a herringbone pattern with abundant light and views of the Brooklyn Museum, Prospect Park and Manhattan Skyline.
- Poliform Varenna kitchens offer custom Smoked Oak cabinetry featuring integrated handles, polished White Carrara marble countertops with island waterfall feature and Miele appliance package.
- Master bathrooms feature White Carrara marble floors and walls with Smoked Dark Oak and Carrara stone top vanities, Toto wall-mounted toilets and Hydro Systems soaking tub.
- Secondary bathrooms present Crystal Wood marble floors and walls with Smoked Dark Oak Toto wall-mounted toilets.

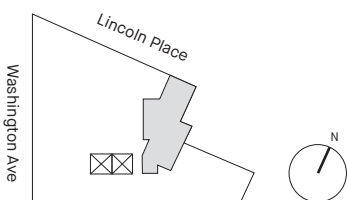

0 1 2 4 6 8 10

Scale: 1/8"=1'-0"

All dimensions are approximate and subject to normal construction variances and tolerances. Gross square footage exceeds the usable floor area. Sponsor reserves the right to make changes, from time to time, in accordance with the terms of the Offering Plan. Plans and dimensions may contain minor variations from floor to floor. The complete terms are in an offering plan available from the Sponsor, under New York State Department of Law File No. CD#18-0281. Sponsor: 805 Washington Ave LLC, 884 Eastern Parkway, Brooklyn, NY 11213. Equal Housing Opportunity.